



# PAK Series 3-Phase

# 0.4kW

## ■ SPECIFICATION

### ■ MOTOR

출력 Output (kW)	기종명 Model Name	극수 Poles	전압 Voltage (V)	주파수 Freq. (Hz)	정격 부하 [Rated Load]			사용 조건 Duty	보호 등급 Degrees of protection	절연 등급 Insulation Classification	냉각 방식 Protective Cooling System
					전류 Current (A)	모터속도 Speed (r/min)	효율 Efficiency (%)				
0.4	PAK□-□-M□040R4□	4	220/380	60	2,00/1,20	1730	74,1	CONT.	IP55 (IP40)	F	Totally Enclosed Fan-Cooled
	PAK□-□-M□040W6□	4	200	50	2,20	1450	74,2				
		4	200/220	60	1,80/1,90	1735/1745	76,4/75,7				
	PAK□-□-M□040X6□	4	380/400	50	1,10/1,10	1425/1430	75,5/74,1				
		4	400/440	60	1,00/1,00	1710/1725	75,4/75,2				

- Brake 부착 Geared Motor는 방수방진 등급이 IP40 비방수형 제품과 IP55 방수형 제품의 2가지 Model 이 있습니다.(The Brake Geared Motor is divided into 2 models: one is a non-water proof product with IP40 while the other is a waterproof product with IP55.)
- IP40 모델과 IP55 모델의 전기적 특성 사양은 동일합니다.(The Models with IP40 and IP55 have the same electric characteristics.)

### ■ GEARED MOTOR – 50Hz

Frame No.	22					28					32					
감속비 (Reduction gear ratio)	5	10	15	20	25	30	40	50	60	80	★100	100	120	160	200	
회전 속도 (Rotation speed (r/min))	300	150	100	75	60	50	37,5	30	25	18,8	15	15	12,5	9,4	7,5	
허용 토크 (Allowable torque)	kgf · m	1,2	2,5	3,7	4,9	6,2	7,4	9,6	11,9	14,3	19,1	19,7	23,9	28,7	38,2	44
	N · m	12	25	36	48	61	73	94	117	140	187	193	234	281	374	431
허용 (Allowable) O.H.L	kgf	80	120	140	150	170	260	290	320	350	350	350	500	600	600	600
	N	882	1180	1370	1470	1670	2550	2840	3140	3430	3430	3430	4900	5880	5880	5880

### ■ GEARED MOTOR – 60Hz

Frame No.	22					28					32					
감속비 (Reduction gear ratio)	5	10	15	20	25	30	40	50	60	80	★100	100	120	160	200	
회전 속도 (Rotation speed (r/min))	360	180	120	90	72	60	45	36	30	22,5	18	18	15	11,2	9	
허용 토크 (Allowable torque)	kgf · m	1	2,1	3,1	4,1	5,1	6,2	8	10	11,9	15,9	16,4	19,9	23,9	31,9	39,8
	N · m	10	21	30	40	50	61	78	98	117	156	161	195	234	313	390
허용 (Allowable) O.H.L	kgf	90	120	140	150	170	260	290	320	350	350	350	500	600	600	600
	N	882	1180	1370	1470	1670	2550	2840	3140	3430	3430	3430	4900	5880	5880	5880

- Note) • Permissible O.H.L (허용 Overhung 하중)의 적용은 출력축 Shaft 인출 길이의 중심부 기준임.(Permissible O.H.L (allowable overhung load) is based on the central part of the outlet length for output shaft)
- “★” 표시된 감속비의 제품은 Permissible Torque(허용토크)가 제한됩니다.(Permissible Torque is limited for products with a mark “★” of reduction gear ratio)
  - 회전 방향은 ■ 색이 Motor의 회전방향과 동일 방향이고, 나머지는 Motor 회전방향과 반대방향 입니다.(■ Color indicates the same direction of motor rotation, while other color indicates the opposite direction of motor rotation.)

기종명 (Model Name) Coding  
▶ 36Page

출력축 사양 (Specification for output shaft)  
▶ 70Page

기술자료 (Technological Data)  
▶ 101Page

UNIT = mm

■ PAK TYPE DIMENSIONS [ Lead Box Type ]

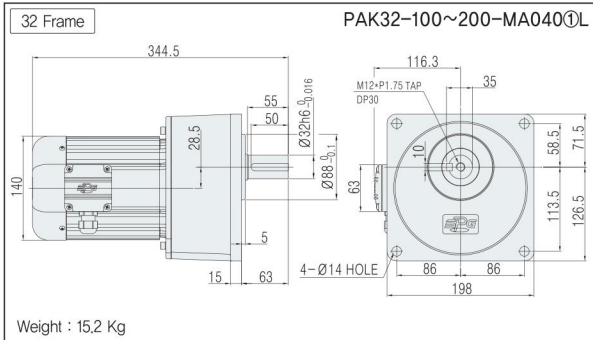
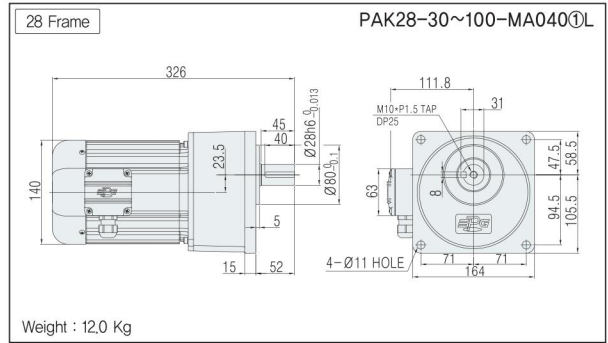
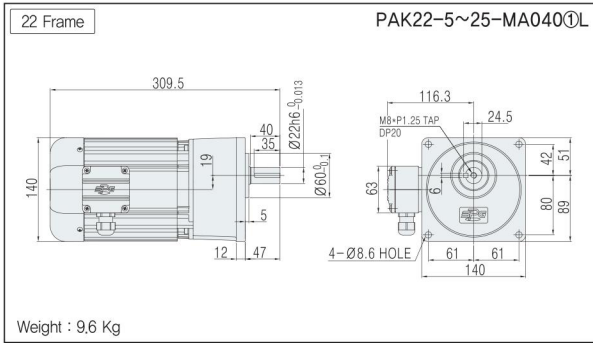

• 기종명 구분(Model type) ① : 전원(Power) (Voltage & Frequency)

■ 0.2~0.75kW용 리드 박스  
(Lead wire Box for 0.2~0.75kW)

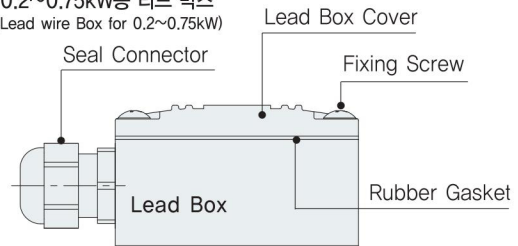

■ PAK TYPE DIMENSIONS [ Terminal Box Type ]

- Note) • IP40 모델과 IP55 모델의 외관 치수는 동일합니다.(Dimensions for IP40 model and IP55 model are the same.)  
 • BRAKE 부착 모델은 Terminal Box Type 을 기본으로 적용하고 있으며, Lead Box Type 은 적용하고 있지 않습니다.(The brake-attached model is applied to the Terminal Box Type for basic features, but does not apply to the lead wire box type.)  
 • Dimensions 내의 ( ) 치수 및 중량은 Brake 부착 모델의 사양입니다.( ( ) dimension and weight in dimensions is for brake attached model specification)

UNIT = mm

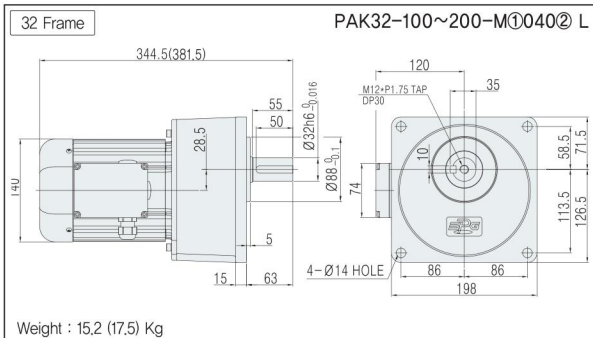
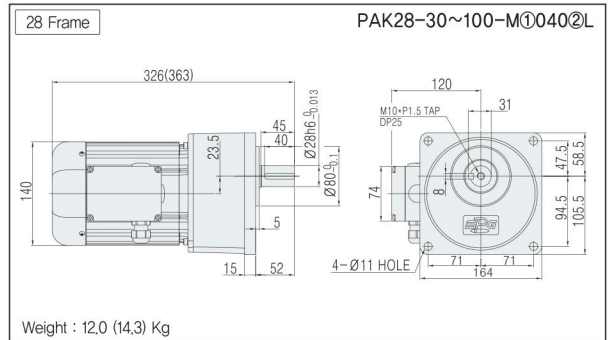
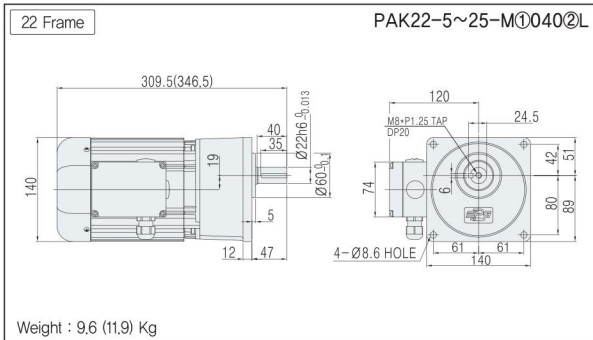

• 기종명 구분(Model type) ① : 모터옵션(Motor option) (B, C, D)  
 ② : 전원(Power) (Voltage & Frequency)

■ 0.2~0.75kW용 리드 박스  
(Lead wire Box for 0.2~0.75kW)

