



PAL Series 3-Phase

0.4kW

■ SPECIFICATION

■ MOTOR

출력 Output (kW)	기종명 Model Name	극수 Poles	전압 Voltage (V)	주파수 Freq. (Hz)	정격 부하 [Rated Load]			사용 조건 Duty	보호 등급 Degrees of protection	절연 등급 Insulation Classification	냉각 방식 Protective Cooling System
					전류 Current (A)	모터속도 Speed (r/min)	효율 Efficiency (%)				
0.4	PAL□-□-M□040R4□	4	220/380	60	2.00/1.20	1730	74.1	CONT.	IP55 (IP40)	F	Totally Enclosed Fan-Cooled
	PAL□-□-M□040W6□	4	200	50	2.20	1450	74.2				
		4	200/220	60	1.80/1.90	1735/1745	76.4/75.7				
	PAL□-□-M□040X6□	4	380/400	50	1.10/1.10	1425/1430	75.5/74.1				
		4	400/440	60	1.00/1.00	1710/1725	75.4/75.2				

- Brake 부착 Geared Motor는 방수방진 등급이 IP40 비방수형 제품과 IP55 방수형 제품의 2가지 Model 이 있습니다.(The Brake Geared Motor is divided into 2 models: one is a non-water proof product with IP40 while the other is a waterproof product with IP55.)
- IP40 모델과 IP55 모델의 전기적 특성 사양은 동일합니다.(The Models with IP40 and IP55 have the same electric characteristics.)

■ GEARED MOTOR – 50Hz

Frame No.	22					28					32					
감속비 (Reduction gear ratio)	5	10	15	20	25	30	40	50	60	80	★100	100	120	160	200	
회전 속도 (Rotation speed (r/min))	300	150	100	75	60	50	37.5	30	25	18.8	15	15	12.5	9.4	7.5	
허용 토크 (Allowable torque)	kgf · m	1.2	2.5	3.7	4.9	6.2	7.4	9.6	11.9	14.3	19.1	19.7	23.9	28.7	38.2	44
	N · m	12	25	36	48	61	73	94	117	140	187	193	234	281	374	431
허용 (Allowable) O.H.L	kgf	90	120	140	150	170	260	290	320	350	350	350	500	600	600	600
	N	882	1180	1370	1470	1670	2550	2840	3140	3430	3430	3430	4900	5880	5880	5880

■ GEARED MOTOR – 60Hz

Frame No.	22					28					32					
감속비 (Reduction gear ratio)	5	10	15	20	25	30	40	50	60	80	★100	100	120	160	200	
회전 속도 (Rotation speed (r/min))	360	180	120	90	72	60	45	36	30	22.5	18	18	15	11.2	9	
허용 토크 (Allowable torque)	kgf · m	1	2.1	3.1	4.1	5.1	6.2	8	10	11.9	15.9	16.4	19.9	23.9	31.9	39.8
	N · m	10	21	30	40	50	61	78	98	117	156	161	195	234	313	390
허용 (Allowable) O.H.L	kgf	90	120	140	150	170	260	290	320	350	350	350	500	600	600	600
	N	882	1180	1370	1470	1670	2550	2840	3140	3430	3430	3430	4900	5880	5880	5880

- Note) • Permissible O.H.L (허용 Overhung 하중)의 적용은 출력축 Shaft 인출 길이의 중심부 기준임.(Permissible O.H.L (allowable overhung load) is based on the central part of the outlet length for output shaft)
- “★” 표시된 감속비의 제품은 Permissible Torque(허용토크)가 제한됩니다.(Permissible Torque is limited for products with a mark “★” of reduction gear ratio)
 - 회전 방향은 ■ 색이 Motor의 회전방향과 동일 방향이고, 나머지는 Motor 회전방향과 반대방향 입니다.(■ Color indicates the same direction of motor rotation, while other color indicates the opposite direction of motor rotation.)

기종명 (Model Name) Coding
▶ 36Page

출력축 사양 (Specification for output shaft)
▶ 70Page

기술자료 (Technological Data)
▶ 101Page

UNIT = mm

■ PAL TYPE DIMENSIONS [Lead Box Type]

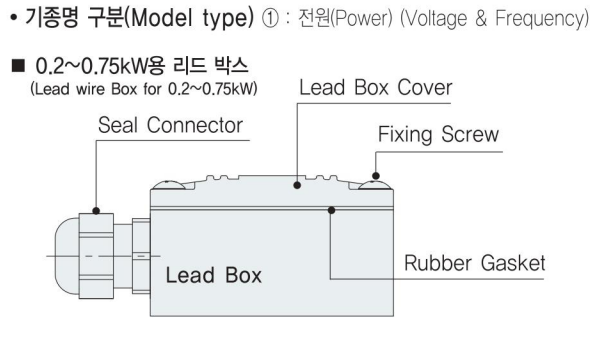
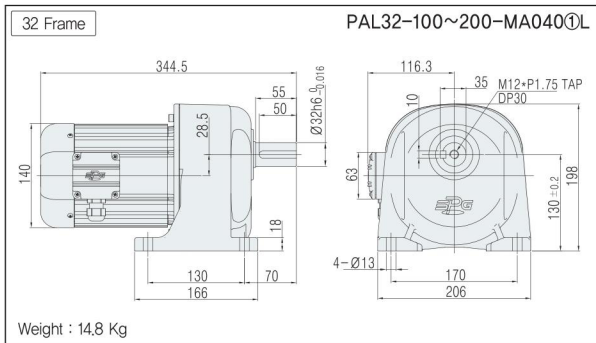
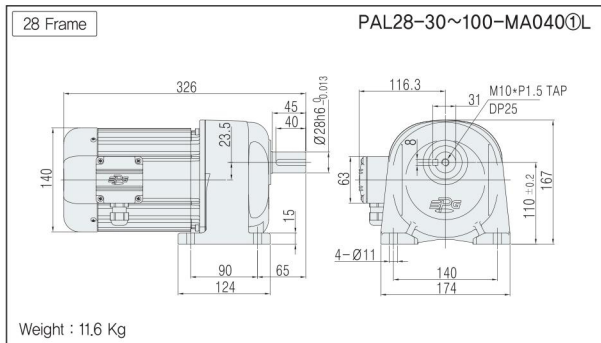
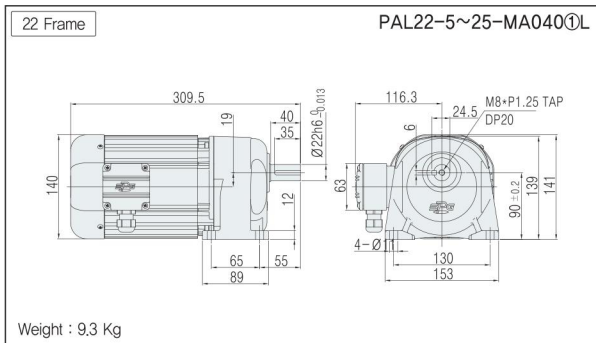

- 기종명 구분(Model type) ① : 전원(Power) (Voltage & Frequency)
- 0.2~0.75kW용 리드 박스 (Lead wire Box for 0.2~0.75kW)

■ PAL TYPE DIMENSIONS [Terminal Box Type]

- Note) • IP40 모델과 IP55 모델의 외관 치수는 동일합니다.(Dimensions for IP40 model and IP55 model are the same.)
- BRAKE 부착 모델은 Terminal Box Type 을 기본으로 적용하고 있으며, Lead Box Type 은 적용하고 있지 않습니다. (The brake-attached model is applied to the Terminal Box Type for basic features, but does not apply to the lead wire box type.)
 - Dimensions 내의 () 치수 및 중량은 Brake 부착 모델의 사양입니다. ((dimension and weight in dimensions is for brake attached model specification))

UNIT = mm

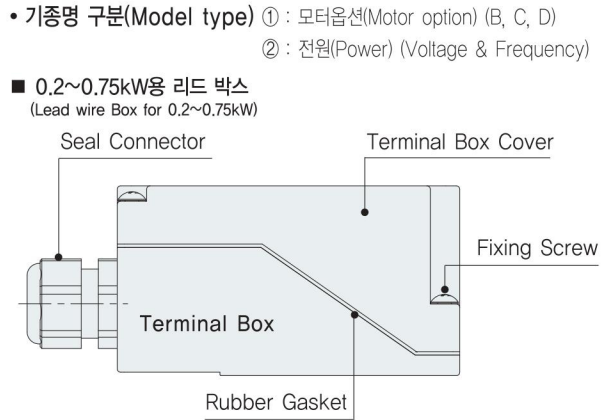
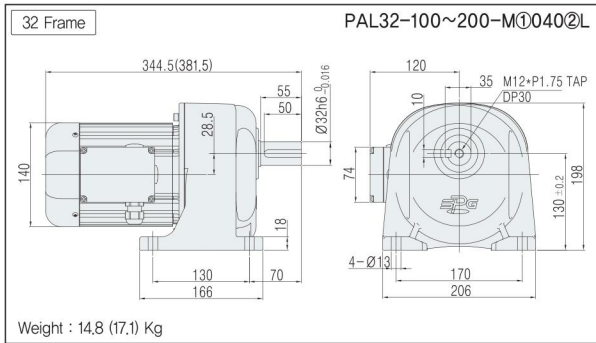
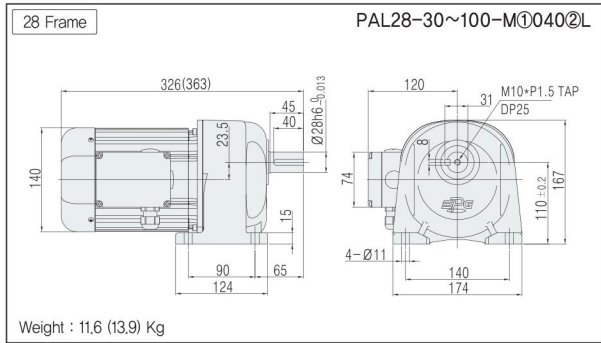
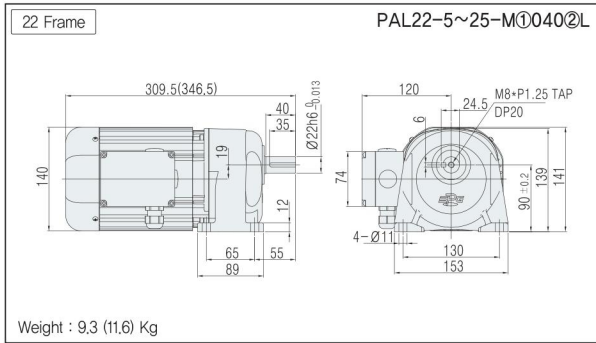

- 기종명 구분(Model type) ① : 모터옵션(Motor option) (B, C, D)
- ② : 전원(Power) (Voltage & Frequency)
- 0.2~0.75kW용 리드 박스 (Lead wire Box for 0.2~0.75kW)